

## READ THESE INSTRUCTIONS BEFORE USING THIS GUN

MODEL  
SHOWN  
C22LRB



### WARNING

PLACE HAMMER IN HALF COCK  
POSITION & ENGAGE SAFETY  
BEFORE LOADING & UNLOADING



COBRA ENTERPRISES, INC.

## GUN SAFETY **WARNINGS**

Do not use this derringer until you have completely read this instruction manual. We strongly recommend that you seek competent firearms instruction before attempting to use this gun. Failure to follow these gun safety instructions may result in injury or death to you or another.

1

### WARNINGS

1. **ALWAYS** use proper **shooting glasses** to prevent eye injury!
2. **ALWAYS** use **hearing protection** to prevent ear damage!
3. **Never carry a gun loaded** while walking, or climbing or anywhere you might slip and fall, dropping the gun. A gun that is dropped, bumped or jarred with a live round in the chamber it might accidentally discharge even with the safety on causing injury to you or someone else.
4. **Never carry a loaded gun** in a motor vehicle and never carry a loaded gun into a dwelling.

5. **Never rely on the safety** to prevent accidental discharge. The safety may not prevent an accidental discharge due to dropping, jarring or bumping of the gun.
6. **Never alter any part in your gun.** Only use Cobra Enterprises replacement parts.
7. **Only use factory loaded ammunition** for which the gun is chambered as indicated on the barrel to prevent excessive pressure and possible serious personal injury.
8. **Reloaded ammunition can cause serious injury** and damage to the firearm due to stress failure and/or excessive pressure.
9. **Always check the barrel to insure that it is free of obstructions** before loading and firing the firearm. If you experience a light recoil or "off" sound, **CHECK THE BARREL.**

3

10. **Never point a gun at anything you do not intend to shoot.**
11. **Always keep your gun pointed in a safe direction** while loading and unloading to prevent serious injury in case of accidental discharge.
12. **Never place your finger on the trigger** unless you are ready to shoot.
13. **Never shoot at a hard flat surface or at any water surface** to avoid a ricochet and possible serious injury to yourself or a bystander.
14. **Always store guns unloaded in a safe or lock box** separate from ammunition and in a clean dry place **out of reach of children.**

4

#### **LEAD WARNING**

Discharging firearms in a poorly ventilated area, cleaning firearms or handling ammunition may result in exposure to lead, a substance known to cause birth defects, reproductive harm and other serious physical injury. Have adequate ventilation at all times. Wash hands thoroughly after exposure or prior to eating and or drinking.

#### **PRECAUTIONS BEFORE USING**

We strongly advise that you familiarize yourself with all the mechanisms of this gun, or any gun, before using it. We provide reasonable care in the manufacture of this pistol, but assume no responsibility for its care, handling and use!

**ALL FIREARMS ARE DANGEROUS**  
**PLEASE BE CAREFUL!**

5

## **LOADING INSTRUCTIONS**

1. Place hammer in **HALF-COCK POSITION**, and **SAFETY ENGAGED, TO SAFE POSITION**.
2. Disengage the locking lever by turning forward to the unlocked position.
3. Pull the barrel back exposing the breach.
4. Insert a cartridge into each chamber. **Only use standard factory ammunition that the derringer was chambered for. Do not load or fire reloaded, hot loaded, or plus "P" cartridges. These types of ammunition can be dangerous to you or your derringer.**
5. Be sure the hammer is still in **HALF-COCK** position, and **SAFETY ENGAGED**, lower the barrel into the frame, pointing in a safe direction and re-engage the locking lever to the lock position.

6

## **FIRING INSTRUCTIONS**

1. Make sure you are wearing your proper hearing and eye protection.
2. Make sure that your target is clear of any person or hard surfaces, including water to avoid a ricochet and possible serious injury to yourself or a bystander.
3. Point the gun in a safe position while cocking the hammer into the fully cocked position.
4. Disengage the safety to the fire position.
5. Aim the pistol at your intended target with your finger off the trigger until you are ready to fire.
6. Before firing make sure all fingers and hands are away from the muzzle.

7

7. Once fired the selector automatically selects to the next barrel.
8. To fire the other barrel repeat procedures 3, 5 and 6.
9. **DO NOT DRY FIRE!**

## **UNLOADING INSTRUCTIONS**

1. Place hammer in **HALF-COCK POSITION**, and **SAFETY ENGAGED, TO SAFE POSITION**.
2. Disengage the locking lever by turning forward to the unlocked position.
3. Pull the barrel back exposing the breach.
4. Remove the cartridges by sliding the extractor away from the Barrel allowing you to remove the cartridges from the barrel chambers.

8

7. Once fired the selector automatically selects to the next barrel.
8. To fire the other barrel repeat procedures 3, 5 and 6.
9. DO NOT DRY FIRE!

### **UNLOADING INSTRUCTIONS**

1. Place hammer in **HALF-COCK POSITION**, and **SAFETY ENGAGED, TO SAFE POSITION**.
2. Disengage the locking lever by turning forward to the unlocked position.
3. Pull the barrel back exposing the breach.
4. Remove the cartridges by sliding the extractor away from the Barrel allowing you to remove the cartridges from the barrel chambers.

### **CLEANING**

Cobra Enterprises recommends cleaning all guns after use. Avoid using powerful gun solvents. We recommend using WD40 or other similar light oil products.

### **STORING**

**Always store guns unloaded in a safe or lock box separate from ammunition and in a clean dry place out of reach of children.**

### **AMMUNITION NOTES**

1. FOR BEST SHOOTING AND FUNCTION WE RECOMMEND FEDERAL, AMERICAN EAGLE AND PMC AMMUNITION (ON ALL COBRA PRODUCTS).
2. C-22M Derringer we recommend using Federal .22mag ammunition.
3. To load or unload the CB9 you must first push the extractor all the way out and hold it in that position while inserting or removing ammunition.
4. Cobra .32 H&R Magnum Derringer is designed to fire Federal .32 H&R Magnum ammunition ONLY.

## ALWAYS REMEMBER

1. Always keep this derringer in the **half-cock** hammer position and **safety engaged**.
2. Keep all firearms out of reach from children.
3. Keep all firearms stored in a safe or lock box and separate from ammunition.
4. Do not drop or mishandle this gun when loaded, as it may fire if dropped.
5. Never point this gun at anything you do not intend to shoot.
6. Never shoot any firearms while on any type of drug or alcohol.

11

## STANDARD SERIES

MODEL SHOWN C22LR



MODEL C22, C22M, C25, AND C32

12

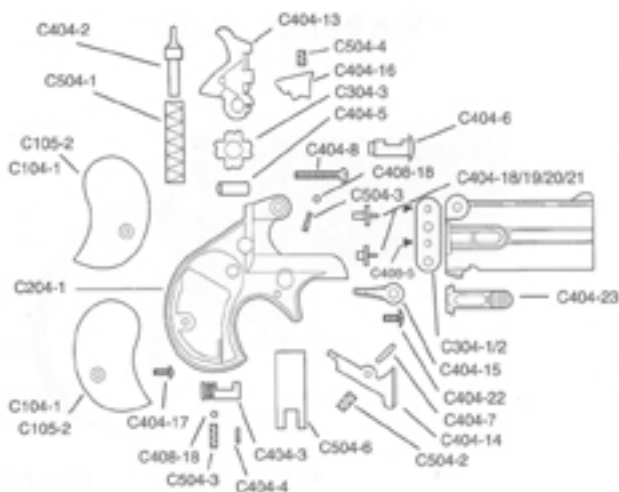

13

## Standard Series Parts

STOCK NO.	Part Name	Price	STOCK NO.	Part Name	Price
C104-1	Pearl Grip (Pair)	7.00	C404-24	Firing Pin Plate Screw	1.00
C105-2	Wood Grip (Pair)	8.00	C404-3	Safety	4.00
C204-1	Frame	N.A.	C404-4	Safety Pin	1.00
C304-1	Firing Pin Plate (center fire)	3.50	C404-18	Firing Pin Top Rimfire (for C22, C22M only)	3.50
C304-2	Firing Pin Plate (rim fire)	3.50	C404-19	Firing Pin Bottom Rimfire (for C22, C22M only)	3.50
C304-3	Cam	3.00	C404-5	Hammer Pivot Pin	5.00
C404-13	Hammer	8.00	C404-6	Lock	4.00
C404-14	Trigger	7.00	C404-7	Trigger Pin	1.50
C404-15	Locking Lever	1.50	C404-8	Hinge Screw	5.00
C404-16	Selector	6.00		Barrels All Calibers	15.00
C404-17	Grip Screw	1.50	C408-18	Safety Ball	1.00
C404-2	Guide Pin	2.00	C504-1	Main Spring	2.00
C404-20	Firing Pin, Top (for C25, C32 only)	3.50	C504-2	Trigger Spring	1.00
C404-21	Firing Pin, Btm (for C25, C32 only)	3.50	C504-3	Safety Spring	1.00
C404-22	Lock Screw	1.00	C504-4	Selector Spring	1.00
C404-23	Extractor	1.50	C504-6	Cam Spring	1.00

Minimum \$4.00 Shipping & Handling  
per order on all parts

14

## BIG BORE & LONG BORE SERIES

MODEL  
SHOWN  
CB38



15

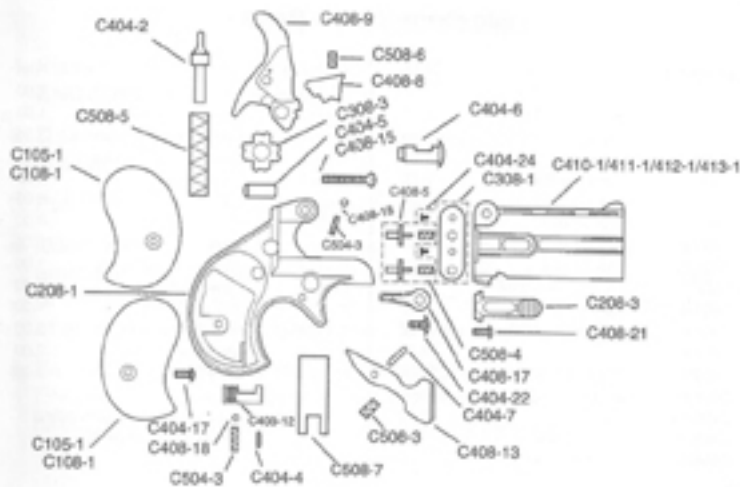

16

## Big Bore Seres Parts

STOCK NO.	Part Name	Price	STOCK NO.	Part Name	Price
C105-1	Wood Grip (Pair)	8.00	C408-18	Lock & Safety Ball	1.00
C108-1	Black Grip (Pair)	4.00	C408-21	Extractor Screw	1.50
C208-1	Frame	N.A.	C408-5B	Center Fire Firing Pin Bottom	3.50
C208-3	Extractor	1.00	C408-5	Firing Pin Center Fire Top	3.50
C308-1	Firing Pin Plate	3.50	C408-6	Firing Pin Rim Fire	3.50
C308-3	Cam	3.00	C408-8	Selector	6.00
C404-17	Grip Screw	1.50	C408-9	Hammer	8.00
C404-2	Guide Pin	2.00		Barrels All Calibers	18.00
C404-22	Lock Screw	1.00	C504-3	Lock & Safety Spring	1.00
C404-24	Firing Plate Screw	1.00	C504-4	Selector Spring	1.00
C404-4	Safety Pin	1.00	C508-3	Trigger Spring	1.00
C404-5	Hammer Pivot Pin	1.50	C508-4	Firing Pin Spring	1.00
C404-6	Lock	4.00	C508-5	Main Spring	2.00
C404-7	Trigger Pin	1.50	C508-7	Cam Spring	1.00
C404-8	Safety	4.00			
C408-13	Trigger	7.00			
C408-15	Hinge Screw	1.50			
C408-17	Locking Lever	1.50			

Minimum \$4.00 Shipping & Handling  
per order on all parts

17

**YOUR LIFETIME WARRANTY** SERIAL Number

To activate this warranty you must complete this card and mail, with proper postage, within 30 days of purchase.

MODEL \_\_\_\_\_ CALIBER \_\_\_\_\_ DATE PURCHASE \_\_\_\_/\_\_\_\_/\_\_\_\_

Where did you purchase this pistol? Store \_\_\_\_\_

City \_\_\_\_\_ ST \_\_\_\_\_ Zip \_\_\_\_\_

1. Is this your first purchase of a firearm? YES/NO
2. Did you receive this pistol in a COBRA ENTERPRISES, INC. box with the operating instructions for the pistol you purchased? YES/NO
3. Did you read and understand all of the operating instructions? YES/NO
4. Did you receive any verbal instruction from a competent firearms instructor, on the safe handling of this pistol? YES/NO

IF YOU ANSWERED NO TO #3 or #4., IT IS OUR **STRICT RECOMMENDATION** FOR YOUR SAFETY AND THE SAFETY OF OTHERS, THAT YOU DO NOT ATTEMPT TO LOAD, OR OPERATE, THIS PISTOL UNTIL YOU HAVE OBTAINED SAFE HANDLING INSTRUCTIONS BY A QUALIFIED FIREARMS INSTRUCTOR!

Customer Name (Print) \_\_\_\_\_

Customer Address (Print) \_\_\_\_\_

City \_\_\_\_\_

State \_\_\_\_\_ Zip \_\_\_\_\_

Customer Signature \_\_\_\_\_

### THIS IS YOUR LIFETIME WARRANTY CARD

PLEASE MAIL IN AN ENVELOPE

**COBRA ENTERPRISES, INC.**  
1960 S. MILESTONE DRIVE SUITE F  
SALT LAKE CITY, UT 84104  
801-908-8300

19

**SAFETY GLASSES SHOULD BE WORN AT ALL TIMES  
REMEMBER, CARELESSNESS CAUSES CALAMITY.  
LEARN TO BE A SAFE SHOOTER SO THAT YOU CAN  
ENJOY YOUR PISTOL FOR MANY YEARS.  
THERE ARE NO SAFE GUNS... THERE ARE ONLY  
SAFE GUN OWNERS.**

**RESPECTFULLY**



20

**Notes**





1960 S. MILESTONE DRIVE, SUITE F  
SALT LAKE CITY, UT 84104  
801-908-8300  
[www.cobrapistols.com](http://www.cobrapistols.com)

# Firearm Accessories

Click on links below



**Sinclair** AMMUNITION

When you don't have time to load it yourself  
Quality ammunition at competitive prices [▶ SHOP NOW](#)

Remington CCI IMI FEDERAL PREMIUM

The advertisement features a man in a light-colored shirt and dark pants kneeling on a grassy field, looking towards the right. A dog is lying down next to him. In the foreground, there are several boxes of ammunition, including Kent and Winchester brands. The background shows a line of trees under a clear sky.



**SAVE 10%** SITE WIDE  
**& FREE** FEDEX GROUND SHIPPING ON ORDERS OVER \$50

**GALLS**

The advertisement has a dark blue background. It features a red and black tactical bag, a pair of black boots, and several stacks of ammunition boxes. The text is in white and blue, with the brand name 'GALLS' in a stylized white font at the bottom.