

## O.H.V. 61 AND 74 V TYPE ENGINE BASE ASSEMBLY

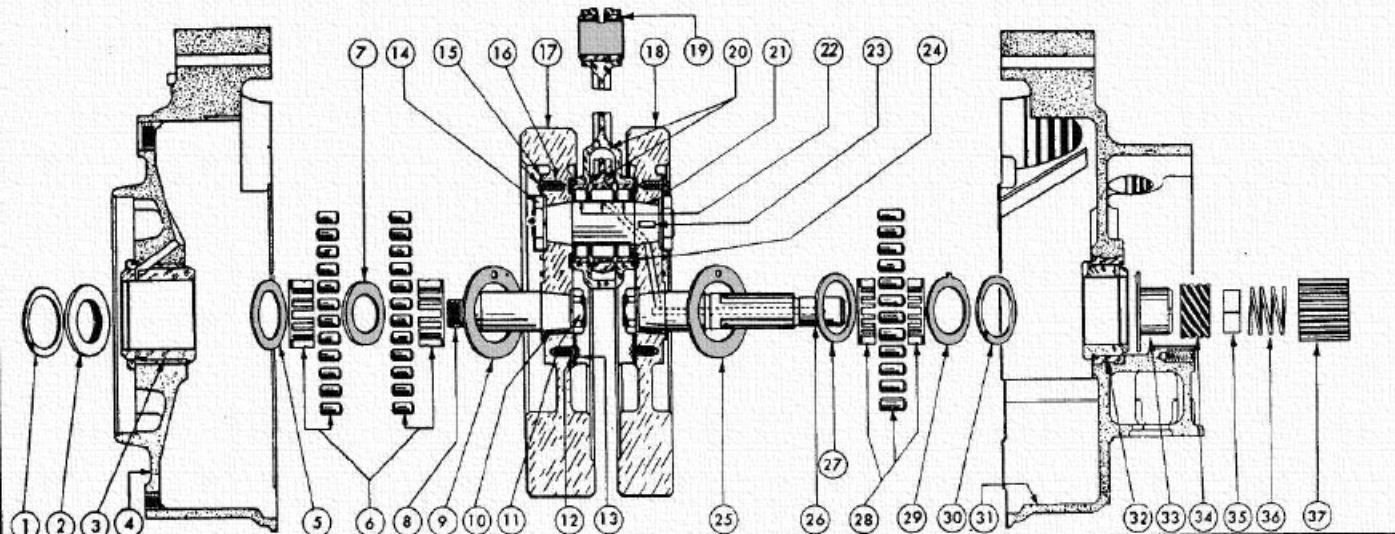

ITEM NUMBER	NUMBER USED	DESCRIPTION	ITEM NUMBER	DESCRIPTION
	2	BEARING SPRING RING — (Same as Item 30)	17	
	1	OIL RETAINING BUSHING — Press fit in Item 3	18	
	1	LEFT CRANK CASE ROLLER BEARING BUSHING — .0075" Press fit in case.	19	
4		SET OF CRANK CASES — NOTE: When only one-half case is damaged and needs to be replaced, return good half to the factory to be properly matched with a new half case.	20	
31	1	1940 - 61 OHV, left case is No. 406-40A and right case is No. 410-40A. 1941 and later 61 and 74 OHV, left case is No. 400-41 and right case is No. 410-41.	21	
5	1	SPROCKET SHAFT BEARING WASHER	22	
6	1	SPROCKET SHAFT ROLLER BEARING COMPLETE — Fit this bearing .0005" to .001" loose. Bearing consists of 2 No. 417-30 retainers and 24 No. 2289-25 rollers. (See "FOOTNOTE NO. 2.")	23	
7	1	SPROCKET SHAFT ROLLER BEARING SPACER	24	
8	1	SPROCKET SHAFT	25	
9	2	FLYWHEEL THRUST COLLAR — .066" to .102" in steps of .004" — Same as Item 32).	26	
10	2	SHAFT KEY	27	
11	1	SPROCKET SHAFT AND GEAR SHAFT NUT	28	
12	4	CRANK PIN AND SHAFT NUT LOCK WASHER	29	
13	2	SPROCKET SHAFT AND GEAR SHAFT NUT LOCK WASHER	30	
14	4	LOCK WASHER SCREW — (Same as Item 16)	31	
15	2	CRANK PIN NUT	32	
16	2	CRANK PIN NUT LOCK WASHER — (See Item 12)	33	

ITEM NUMBER	NUMBER USED	DESCRIPTION	ITEM NUMBER	DESCRIPTION
	1	LEFT FLYWHEEL — When assembled, allow .012" to .014" and play in crankcase. Adjust and play with colors (Items 9 and 23).	34	
	2	RIGHT FLYWHEEL	35	
	1	PISTON PIN BUSHING — Ream or hone to fit piston pin .001" loose.	36	
	1	SET OF CONNECTING RODS — with crank pin and roller bearing complete (Includes Items 14, 21 and 22). Forked (rear) rod side play .006" to .010" between flywheel washers (Item 24). Forked (rear) rod is No. 285-36 and single and (front) rod is No. 286-36.	37	
	1	CRANK PIN		
	1	CRANK PIN ROLLER BEARING COMPLETE — Fit this bearing .001" to .0012" loose. Bearing consists of 4 No. 301-40 retainers, 18 No. 304-40 long rollers and 36 No. 304-40 short rollers. (See "FOOTNOTE NO. 1")		
	1	CRANK PIN KEY		
	2	FLYWHEEL STEEL WASHER		
	1	GEAR SHAFT		
	1	GEAR SHAFT ROLLER BEARING SPACER		
	1	GEAR SHAFT ROLLER BEARING COMPLETE — Fit this bearing .0008" to .0012" loose. Bearing consists of 2 No. 415-36 retainers and 12 No. 306-36 rollers. (See "FOOTNOTE NO. 2.")		
	1	GEAR SHAFT BEARING WASHER		
	1	RIGHT CRANK CASE ROLLER BEARING BUSHING — .0015" Press fit in case.		
	1	GEAR SHAFT BEARING OIL SEAL RING		
	1	OIL PUMP FLYWHEEL SHAFT GEAR (SPIRAL GEAR)		
	1	OIL PUMP GEAR AND PINION GEAR SPACER		
	1	BEARING OIL SEAL RING SPRING		
	1	PISTON GEAR		

FOOTNOTE NO. 1 — Referring to Item 32. Diameter of standard roller is .1875". Complete bearings are available with rollers from standard to .001" oversize in steps of .0002".

FOOTNOTE NO. 2 — Referring to Items 6 and 28. Diameter of standard rollers is .250". Complete bearings are available with rollers from standard to .001" oversize in steps of .0002".