

CLUTCH (1966-1969)

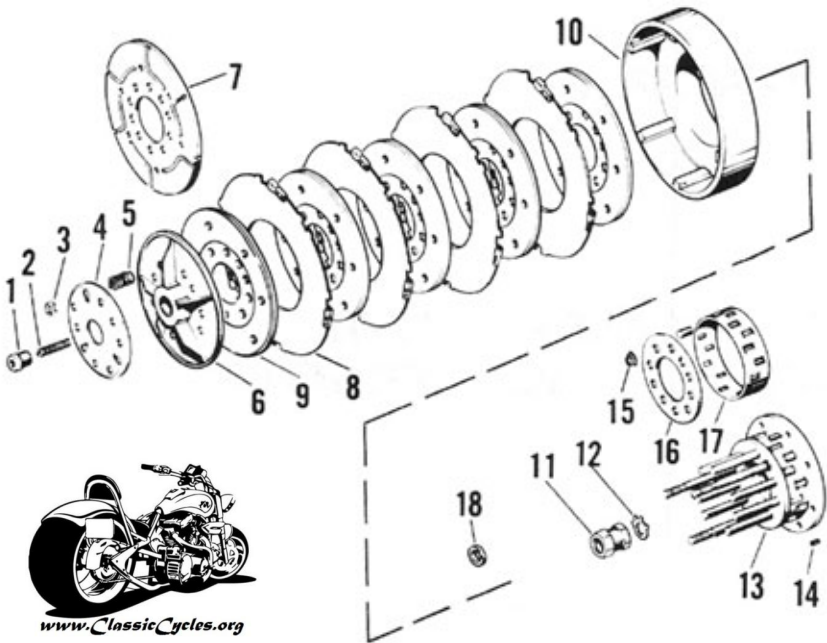

1. Pushrod adjusting screw locknut
2. Adjusting screw
3. Spring tension adjusting nut
4. Spring collar
5. Springs
6. Pressure plate
7. Spring disc (1966-1967)
8. Steel disc
9. Friction disc
10. Clutch shell
11. Clutch hub nut
12. Hub nut lockwasher
13. Clutch hub
14. Clutch hub key
15. Bearing plate spring
16. Bearing plate
17. Bearing retainer
18. Hub nut seal

